

The *Elite* Agricultural Series



Installation Guide

Order Code: AG

BORE	ROD DIA.	A	B	C	D	E	F	G	H	I	J	K	L	M	N	O	P	Q
2"	1 1/4"	311	61	9/16"	22	76	202	153	75	50	27	27	51	68	50	25	27	51
2 1/2"	1 1/2"	311	73	3/4"	30	82	174	109	82	52	28	27	65	80	50	26	27	59
3"	1 1/2"	311	87	3/4"	30	84	169	104	82	52	28	27	65	94	50	26	27	59
3 1/2"	1 3/4"	311	100	3/4"	30	84	169	104	82	52	28	27	65	111	50	26	27	59
4"	1 3/4"	311	114	3/4"	30	88	158	93	82	52	28	27	65	N/A	50	32	27	59
5"	2"	311	143	3/4"	30	88	163	91	85	55	32	28	78	N/A	50	32	27	78

2, 2 1/2", 3 & 3 1/2" cylinders have external gland nut.

4" & 5" cylinders have internal threaded gland.

5" cylinders with strokes over 24" have a 2 1/2" diameter piston rod.

All cylinders supplied with 1" diameter clevis pins and clips.

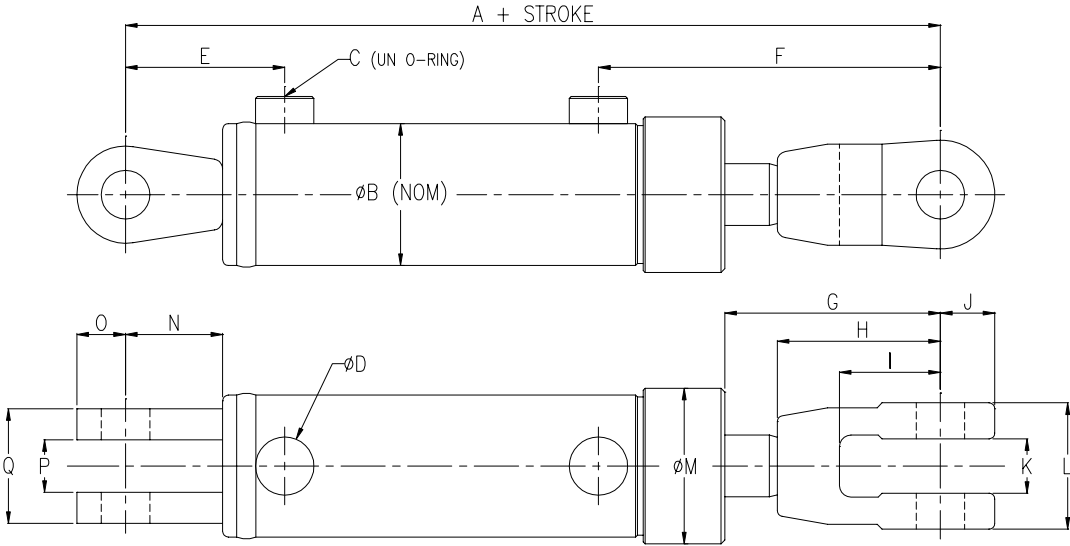

Ezy-Fit Hydraulics
 19 Acrylon Road, Salisbury South SA 5106
 Telephone: (08) 8281 0955 Facsimile: (08) 8281 1698
<http://www.ezyfit.com.au> email: info@ezyfit.com.au